

# Island Park Village Resort



*Be our guest*

1.800.584.7740

www.islandparkrentals.com  
info@islandparkrentals.com

**Directions:** From Highway 20 (in Island Park, Idaho), turn east at mile post #394. This is N. Big Springs Loop Road. (There will be a large yellow sign that says Island Park Village Resort, and you will see a Robins Roost Chevron station on the corner.) Once on Big Springs Loop Road, turn left at the third entrance (Shoshone Road) to Island Park Village Resort. Turn right at the T Intersection. Now you are on Grandview Road. The West Yellowstone Cabin (4239) is at the end of the cul-de-sac (with the teal siding). Do not park or play in the adjacent empty lot. Please be courteous to that lot's owner.

**Door Code:** The code to the cabin lock box is \_\_\_\_\_. Make sure you feel a click as you push each number. Then push the open button towards the ground. This will open the lock box. (If you make a mistake, you will need to push the clear button to start over.) You will need to enter the code again to replace the cover as you hold down the open button. **Upon check out please leave the key on the kitchen bar counter top and lock the door behind you as you leave.**

Two Bear Retreat  
4187 N. Big Springs Loop Rd.

Big Springs Lodge  
4189 N. Big Springs Loop Rd.

Yellowstone Ranchhouse  
4195 N. Big Springs Loop Rd.

Reunion Lodge  
4238 Grand View Rd.

Old Faithful Lodge  
4240 Grand View Rd.

Meadowview Cabin  
4203 Grand View Rd.

Two Top Cabin  
4207 Grand View Rd.

West Yellowstone Cabin  
4239 Grand View Rd.

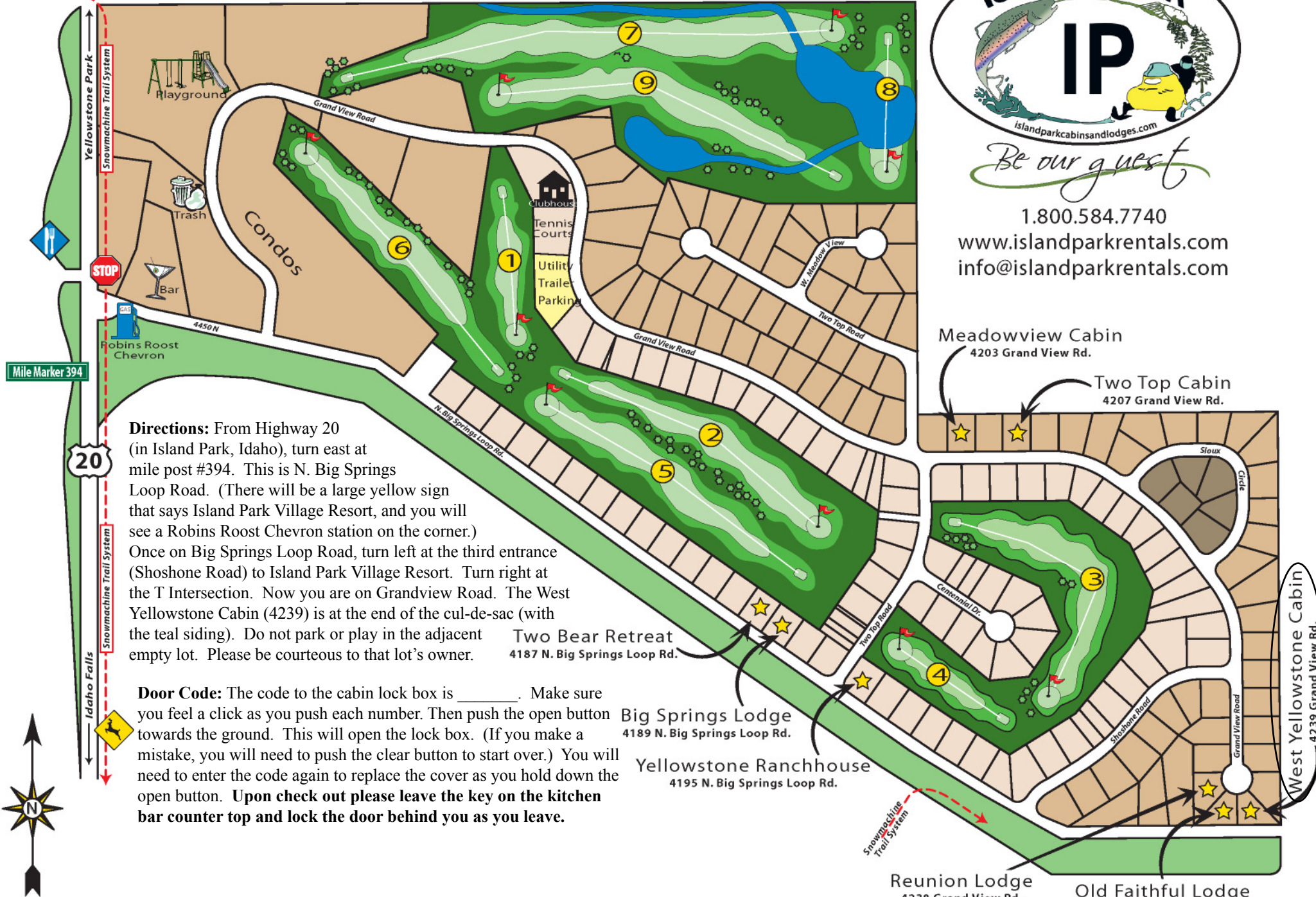

Mile Marker 394

20

Playground

Trash

Bar

Robins Roost Chevron

Condos

Clubhouse  
Tennis Courts  
Utility Trailer Parking

Sluice  
Circle

Snowmachine Trail System

Yellowstone Park  
Snowmachine Trail System

Idaho Falls  
Snowmachine Trail System

Grand View Road

4450 N

N. Big Springs Loop Rd.

Grand View Road

W. Meadow View

Two Top Road

Two Top Road

Genernel Dr.

Shoshone Road

Grand View Road